

ZCKMD39H29

limit switch body ZCKM - 1NO+2NC - snap
action - M20

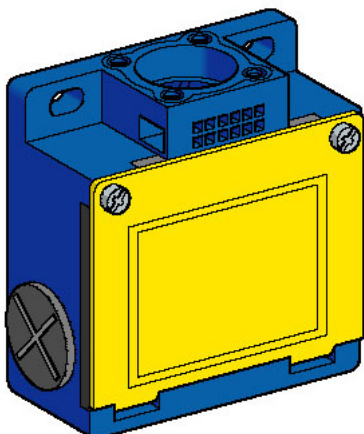

Main

| | |
|---------------------------------------|--|
| Range of product | OsiSense XC |
| Series name | Standard format |
| Product or component type | Limit switch body |
| Device short name | ZCKM |
| Body type | Fixed |
| Product compatibility | XCKM |
| Local display | Without |
| Electrical connection | Screw-clamp terminals , clamping capacity: 1 x 0.34...2 x 0.75 mm ² |
| Cable entry | 3 entries tapped for M20 x 1.5 cable gland |
| Number of poles | 3 |
| Contacts type and composition | 1 NO + 2 NC |
| Contacts operation | Snap action |
| Positive opening | With |
| Ambient air temperature for operation | -25...70 °C for standard environment |
| Environmental characteristic | Standard environment |

Complementary

| | |
|--|---|
| Associated head | ZCKD02 ZCKD05 ZCKD06 ZCKD08 ZCKD10 ZCKD109 ZCKD15 ZCKD16 ZCKD17 ZCKD21 ZCKD219 ZCKD23 ZCKD239 ZCKD29 ZCKD41 ZCKD59 ZCKD81 ZCKD91 |
| Body material | Metal |
| Number of steps | 1 |
| Contacts material | Silver plated contacts |
| Minimum actuation speed | 0.01 m/min |
| Contact code designation | B300 , AC-15 (Ue = 240 V , Ie = 1.5 A), Ithe = 6 A conforming to EN/IEC 60947-5-1 appendix A R300 , DC-13 (Ue = 250 V , Ie = 0.1 A) conforming to EN/IEC 60947-5-1 appendix A |
| [Ui] rated insulation voltage | 300 V conforming to UL 508 contact block 300 V conforming to CSA 22-2 No 14 contact block 400 V degree of pollution 3 conforming to IEC 60947-1 contact block |
| Resistance across terminals | 0.25 mOhm conforming to IEC 60255-7 category 3 |
| [Uimp] rated impulse withstand voltage | 4 kV conforming to IEC 60947-1 4 kV conforming to IEC 60664 |
| Short circuit protection | 6 A by gG cartridge fuse |

| | |
|-----------------------|--|
| Electrical durability | 5000000 cycles , DC-13 (Uc = 24 V), 3 W , load factor: 0.5 , operating rate: < 60 cyc/mn conforming to IEC 60947-5-1 appendix C 5000000 cycles , DC-13 (Uc = 48 V), 2 W , load factor: 0.5 , operating rate: < 60 cyc/mn conforming to IEC 60947-5-1 appendix C 5000000 cycles , DC-13 (Uc = 120 V), 1 W , load factor: 0.5 , operating rate: < 60 cyc/mn conforming to IEC 60947-5-1 appendix C |
| Width | 30 mm |
| Height | 63 mm |
| Depth | 64 mm |
| Product weight | 0.21 kg |

Environment

| | |
|-------------------------------------|-------------------|
| IP degree of protection | IP65 |
| IK degree of protection | IK08 |
| Ambient air temperature for storage | -40...70 °C |
| RoHS EUR conformity date | 4Q2009 |
| RoHS EUR status | Will be compliant |